

CB-0/1/2

Circleblast Internal Pipe Blasters

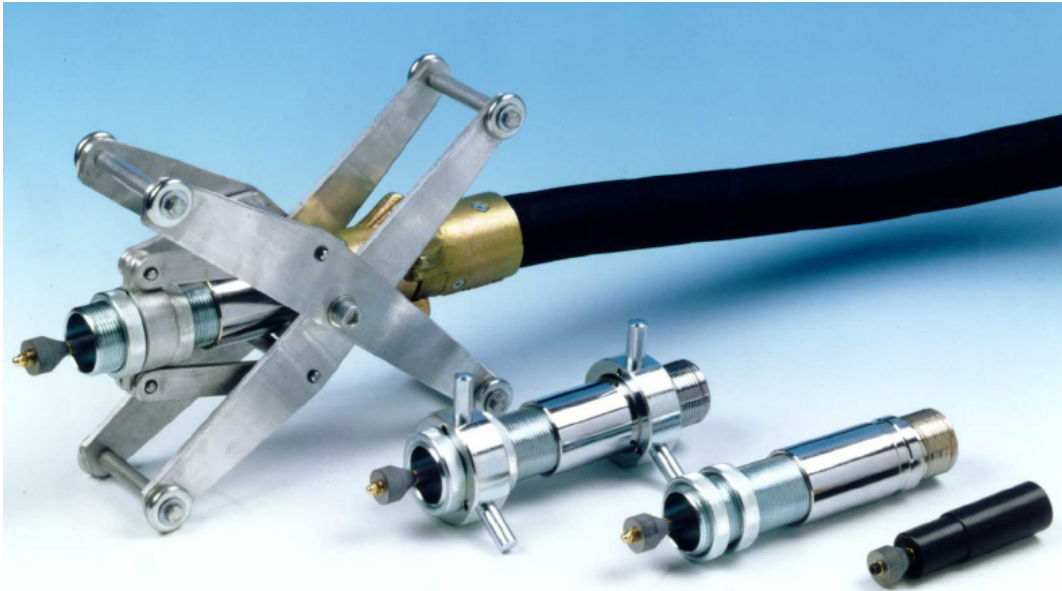

AIRBLAST



The Circleblast Internal Pipe Blasters are designed to blast clean pipe ranging in size from 1 1/4" to 12" (13 to 305 mm) I.D. The tool connects to an abrasive blast machine in place of a standard nozzle. In operation, the Circleblast nozzle directs the air/abrasive mixture at a deflection tip. This tip causes the blast pattern to fan out into a wide, circular pattern, which cleans the inside of the pipe as the tool is passed through. Two centering devices are available to hold the tool in position during passes.

The Circleblast tool is made from the finest materials available. However, some of its internal wear parts are of necessity rather brittle, due to their extreme hardness. The tool should therefore be handled carefully to avoid dropping it or giving it a sharp blow.

PIPEDIAMETER in (mm)	TOOL	TOOL RANGE in (mm)	CENTERING DEVICE	REQUIRED NOZZLE	AIR CONSUMPTION (cfm) (m ³ /min)	
1 1/4" - 3" (32 - 76 mm)	CB-0	1 1/4" - 3" (32 - 76 mm)	-	-	400	11.3
3" - 12" (76 - 305 mm)	CB-1 CB-2	3" - 5" (76 - 127 mm)	CBC-1	AHBN-8 AHBN-10	225 400	6.4 11.3
	CB-1 CB-2	5" - 12" (127 - 305 mm)	CBC-2	AHBN-8 AHBN-10	225 400	6.4 11.3

CB Circleblast Internal Pipe Blasters Assemblies

Part no.	Description
3002100	CB-0 Circleblast for direct mounting on blast hose with 1/2" I.D. (13 x 7 mm) for pipes 1/4" to 3" (35 - 76 mm) I.D. TC deflection tip
3002200	CB-1 Circleblast complete with: 1/2" nozzle HBN-8, CBC-1 centering collars, CBC-2 adjustable centering carriage.
3002300	CB-2 Circleblast complete with: 5/8" nozzle HBN-10, CBC-1 centering collars, CBC-2 adjustable centering carriage.

CB-1/2 Circleblast Internal Pipe Blasters Parts List

Item	Part no.	Description		
01	2112000	AHBN-8 1/2" (13 mm) nozzle TC		1
02	2113000	AHBN-10 5/8" (16 mm) nozzle TC		1
03	3015002	CB-111 Tool holder		1
04	3016000	CB-110/1 Deflection tip TC	◇	1
05	3018001	CB-112/1 Stem support assembly TC	◇	1
06	3020002	CB-113/1 Throat sleeve TC (50mm)	◇	1
07	3020003	CB-113/1 Throat sleeve TC (65mm)	◇	1
08	3023002	CB-115 Throat rod	◇	1
09	3024002	CB-116 Tip holding nut	◇	1
11	3025002	CB-117/1 Protection sleeve for CBC-1		1
12	3025001	CB-117/2 Protection sleeve for CBC-2		1
13	3026002	CB-118 Curled lock nut		2
14	3027002	CB-119 Stem support gasket	◇	2
15	3028000	CB-122 Washer brass	◇	3
16	3029000	CB-123 O-ring	◇	1
17	3029012	Connection tube		1
18	2163000	CFT cast iron quick coupling (optional)		1
19	2135000	CHE-2 nozzle holder, aluminum (optional)		1
20	3016100	CB-110/2 Deflection tip Boron Carbide (optional)		1
21	3016200	CB-110/3 Deflection tip Roctec (optional)		1

All (◇)-marked items are included in Circleblast Spare Parts kit (art.nr. 3022000) in quantities shown.

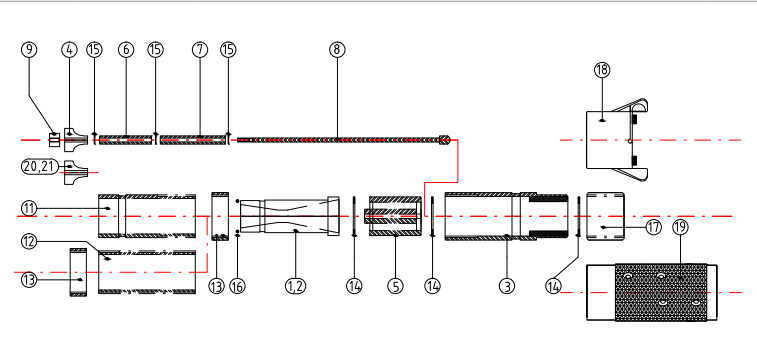

CB-0 Circleblast Internal Pipe Blasters Parts List

Item	Part no.	Description
01	3002500	Housing
02	3002600	Bolt
03	3016000	CB-110/1 Deflection tip TC
04	3028000	CB-122 Washer brass

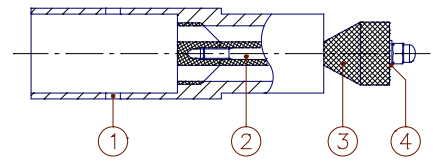

Centering collars for Circleblast

Item	Part no.	Description
	3003000	CBC-1 Centering collars complete for pipes 3" to 5" (76 - 127 mm) I.D. Includes collars and four six-button sets

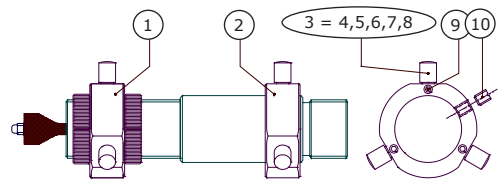

Spare parts for CBC-1 centering collars

01	3004000	Front collar, cad-plate
02	3005000	Rear collar, cad-plate
3	3006000	Complete set of centering pins (5 x set)
4	3006500	Centering pin for 75mm ID pipe (1 pc.)
5	3007000	Centering pin for 83mm ID pipe (1 pc.)
6	3008000	Centering pin for 97mm ID pipe (1 pc.)
7	3009000	Centering pin for 107mm ID pipe (1 pc.)
8	3010000	Centering pin for 123mm ID pipe (1 pc.)
9	3010100	Bolt
10	3010200	Collar locking bolt

Centering carriage for Circleblast

Item	Part no.	Description
	3011000	CBC-2 Centering collars complete for pipes 5" to 12" (127 - 305 mm) I.D.

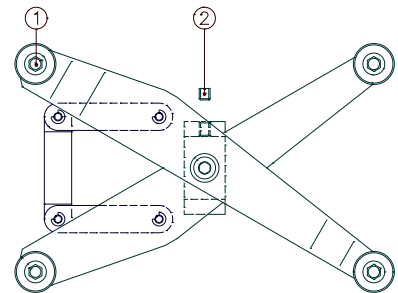

Spare parts for CBC-1 centering collars

01	3012000	Wheel complete
02	3010200	Locking bolt